

30' BY 988' SANITARY EASEMENT

SWANSON ROAD

TRAILHEAD

CONTROL FLY FIELD

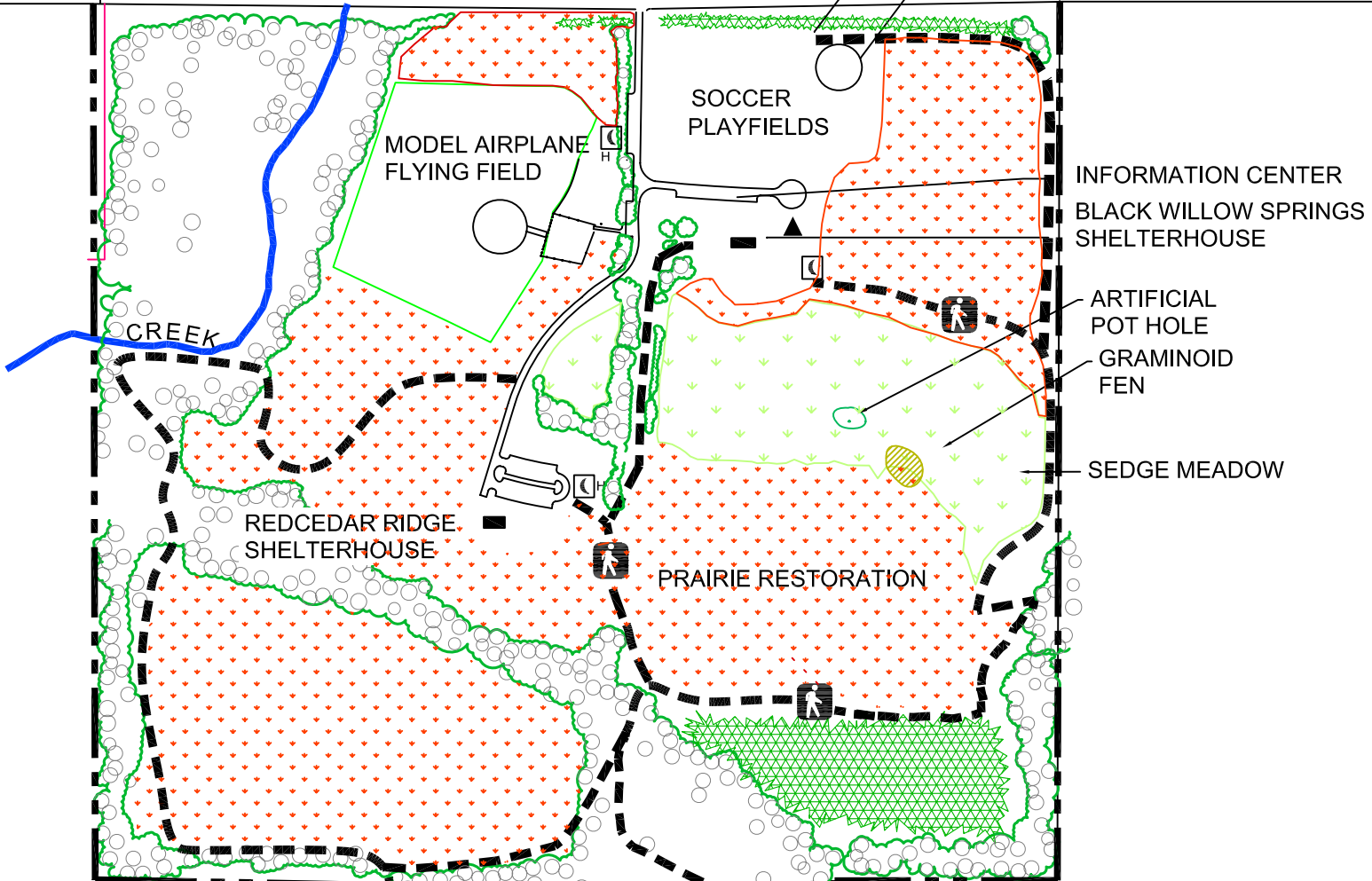

INFORMATION CENTER
BLACK WILLOW SPRINGS
SHELTERHOUSE

ARTIFICIAL
POT HOLE
GRAMINOID
FEN

SEDGE MEADOW

REDCEDAR RIDGE
SHELTERHOUSE

PRAIRIE RESTORATION

PRAIRIE RESTORATION

LEGEND

-  PEDESTRIAN TRAIL
-  SHELTER
-  WELL
-  OUTHOUSE
-  HANDICAP ACCESSIBLE OUTHOUSE
-  PRAIRIE RESTORATION
-  SEDGE MEADOW

DIRECTIONS: 7 1/2 miles north of Rockford on 251 to Swanson Road; east 1/2 mile.

FACILITIES: 211 acre preserve. Soccer fields ball diamond, model airplane flying field, water, toilets, in line flying.

BLACK WILLOW SPRINGS: Wood shelter. 25 tables - seats 150 people. No electricity.

REDCEDAR RIDGE: Wood shelter. 22 tables - seats 132 people. No electricity.

NOTE: Preserve open at 7:00 a.m. - closed 1/2 hour after sunset.

All reservations subject to GENERAL USE REGULATION ORDINANCE.



0 150 300 500FT

KIESELBURG FOREST PRESERVE
5801 SWANSON ROAD



NOVEMBER 2007