

**2010 KIESELBURG FOREST PRESERVE RADIO CONTROLLED FLYING FIELD
POLICY STATEMENT**

This Forest Preserve District Policy Statement is established to assure that no person shall be discriminated against because of his or her political or religious opinions, affiliations, race, sex, color, creed, national origin or disability. It establishes a set of uniform rules and regulations that will govern all use on Forest Preserve District property.

RULES & REGULATIONS

1. Hours of use shall be from 8:00 am until sunset. Winter flying will be permitted subject to clear safe ground conditions.
2. All flyers must have in their possession a current AMA license (or proof of insurance with a minimum of \$100,000 liability coverage) and a Winnebago County Forest Preserve District registration card which must be presented on demand. Registration cards are valid for the calendar year.
3. All flyers must obey the safety rules published in the current AMA model aircraft regulations.
4. All flyers are required to use the established pit area. No taxiing planes in pit area (see map).
5. All flyers must fly from the designated pilot area(s).
6. Break-in or run-in of new engines must be done in a pilot area not in use.
7. When returning to the pit area after a flight, no pilot shall taxi beyond the ready area (see map).
8. Spectators must remain in spectator area (see map).
9. Under no condition shall a transmitter be turned on before a check of the frequency board has been made or a physical check has been made with all other flyers on the same frequency.
10. A muffler is required on all engines, 19 and over, after break-in.
11. A student pilot must be assisted by an instructor until successfully completing 2 solo flights.
12. A dead stick approach has priority over all other aircraft.
13. A downed aircraft is to be retrieved only after notifying all other pilots still in the air and receiving their permission.
14. Flying is not permitted in the following areas:
 - a. over pit area
 - b. over residential areas
 - c. over Swanson Road
 - d. over shelter, picnic, or recreation areas of the preserve.
15. No rockets or remote controlled/engine powered models or toys on flying field other than model aircraft.
16. All flyers are subject to provisions of the Forest Preserve District General Use Regulations.
17. A violation of any of the above rules shall result in the revocation of flying privileges and/or fines under provisions of the General Use Ordinance.
18. Non refundable.

Winnebago County Forest Preserve District
5500 Northrock Drive, Rockford, IL 61103 815-877-6100

2010 APPLICATION FOR KIESELBURG FOREST PRESERVE FLYING FIELD PERMIT

NAME _____ FEE PAID _____ (\$25) # _____

ADDRESS _____ PHONE _____

CITY _____ STATE _____ ZIP _____

POLICIES & RULES

1. Hours of use shall be from 8:00 am until sunset. Winter flying will be permitted subject to clear safe grounds conditions.
2. All flyers must have in their possession a current AMA license (or proof of insurance with a minimum of \$100,000 liability coverage) and a Winnebago County Forest Preserve District registration card which must be presented on demand. Registration cards are valid for the calendar year.
3. All flyers must obey the safety rules published in the current AMA model aircraft regulations.
4. All flyers are required to use the established pit area. No taxiing planes in pit area, (see map).
5. All flyers must fly from the designated pilot area(s).
6. Break-in or run-in of new engines must be done in a pilot area not in use.
7. When returning to the pit area after a flight, no pilot shall taxi beyond the ready area (see map).
8. Spectators must remain in spectator area (see map).
9. Under no condition shall a transmitter be turned on before a check of the frequency board has been made or a physical check has been made with all other flyers on the same frequency.
10. A muffler is required on all engines, 19 and over, after break-in.
11. A student pilot must be assisted by an instructor until successfully completing 2 solo flights.
12. A dead stick approach has priority over all other aircraft.
13. A downed aircraft is to be retrieved only after notifying all other pilots still in the air and receiving their permission.
14. Flying is not permitted in the following areas:
 - a. over pit area
 - b. over residential areas
 - c. over Swanson Road
 - d. over shelter, picnic, or recreation areas of the preserve.
15. No rockets or remote controlled/engine powered models or toys on flying field other than model aircraft.
16. All flyers are subject to provisions of the Forest Preserve District General Use Regulations.
17. A violation of any of the above rules shall result in the revocation of flying privileges and/or fines under provisions of the General Use Ordinance.
18. Non refundable.

I hereby certify that I have read and understand the above policies and rules and will be responsible for carrying them out.

SIGNED _____ DATE _____

30' BY 988' SANITARY EASEMENT

SWANSON ROAD

TRAILHEAD

CONTROL FLY FIELD

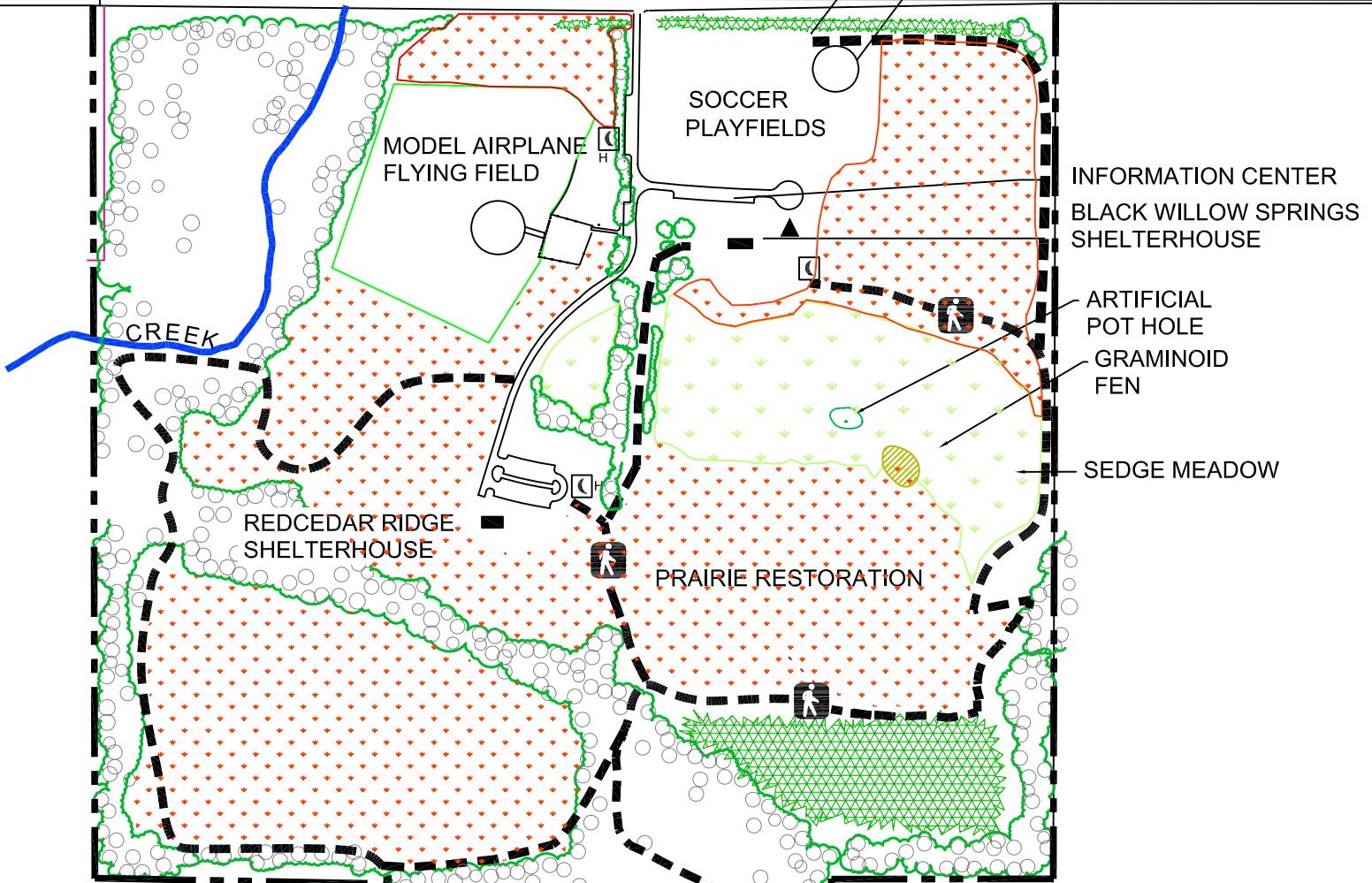

INFORMATION CENTER
BLACK WILLOW SPRINGS
SHELTERHOUSE

ARTIFICIAL
POT HOLE
GRAMINOID
FEN

SEDGE MEADOW

REDCEDAR RIDGE
SHELTERHOUSE

PRAIRIE RESTORATION

PRAIRIE RESTORATION

LEGEND

-  PEDESTRIAN TRAIL
-  SHELTER
-  WELL
-  OUTHOUSE
-  HANDICAP ACCESSIBLE OUTHOUSE
-  PRAIRIE RESTORATION
-  SEDGE MEADOW

DIRECTIONS: 7 ½ miles north of Rockford on 251 to Swanson Road; east ½ mile.

FACILITIES: 211 acre preserve. Soccer fields ball diamond, model airplane flying field, water, toilets, in line flying.

BLACK WILLOW SPRINGS: Wood shelter. 25 tables - seats 150 people. No electricity.

REDCEDAR RIDGE: Wood shelter. 22 tables - seats 132 people. No electricity.

NOTE: Preserve open at 7:00 a.m. - closed ½ hour after sunset.

All reservations subject to GENERAL USE REGULATION ORDINANCE.



0 150 300 500FT

KIESELBURG FOREST PRESERVE
5801 SWANSON ROAD



NOVEMBER 2007